

BHS150 Board Handling System

Expanding your production capacity

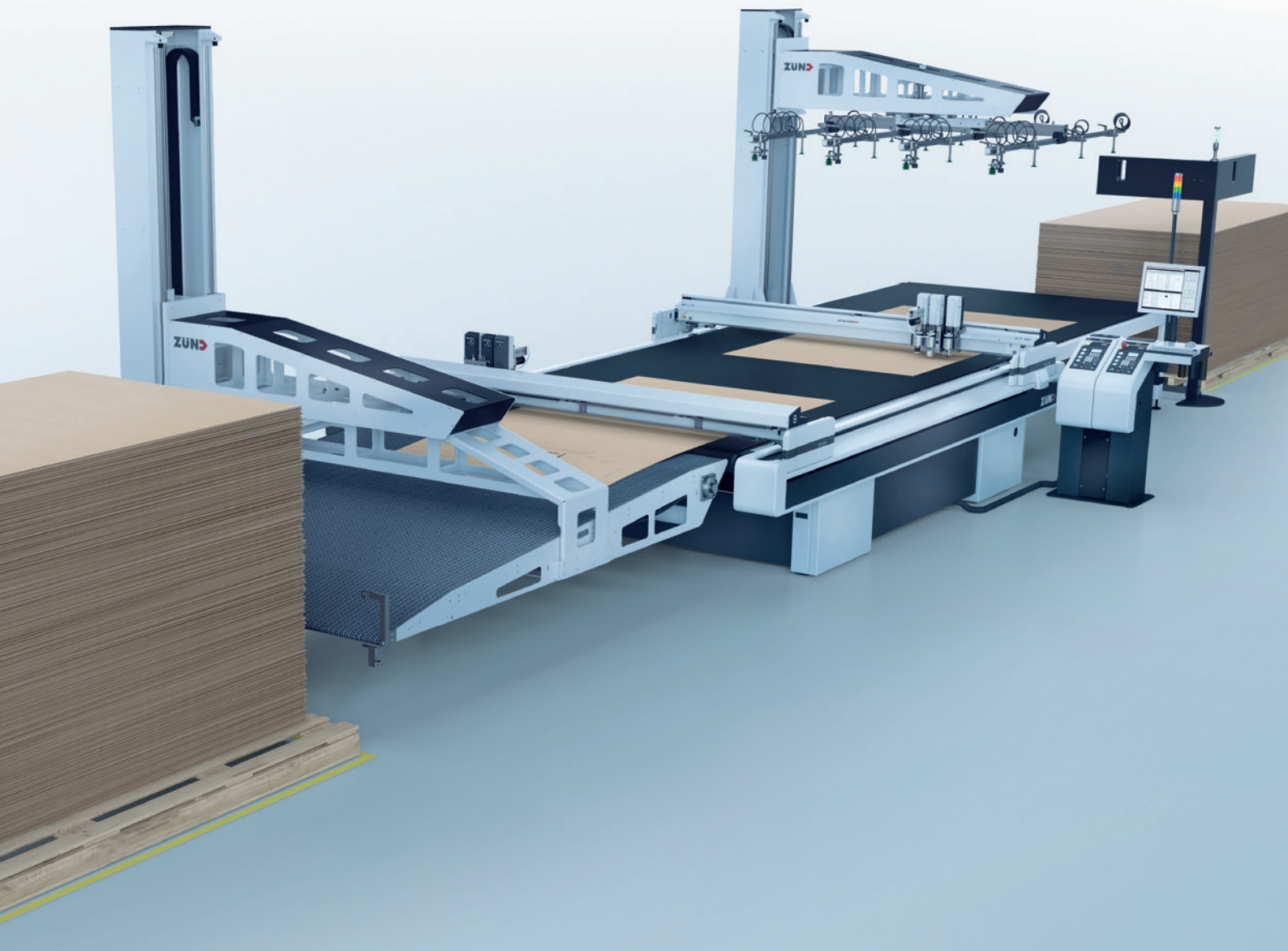

Your first choice in digital cutting.

Digital cutting at an industrial level

The new BHS150 Board Handling System

The unique combination of fully automated material handling and powerful digital cutting capabilities is key to producing at an industrial level. The Zünd BHS150 extends operating time while decreasing operating costs.



Ideal for different material thicknesses
The BHS150 can efficiently process material thicknesses up to 110 mm.

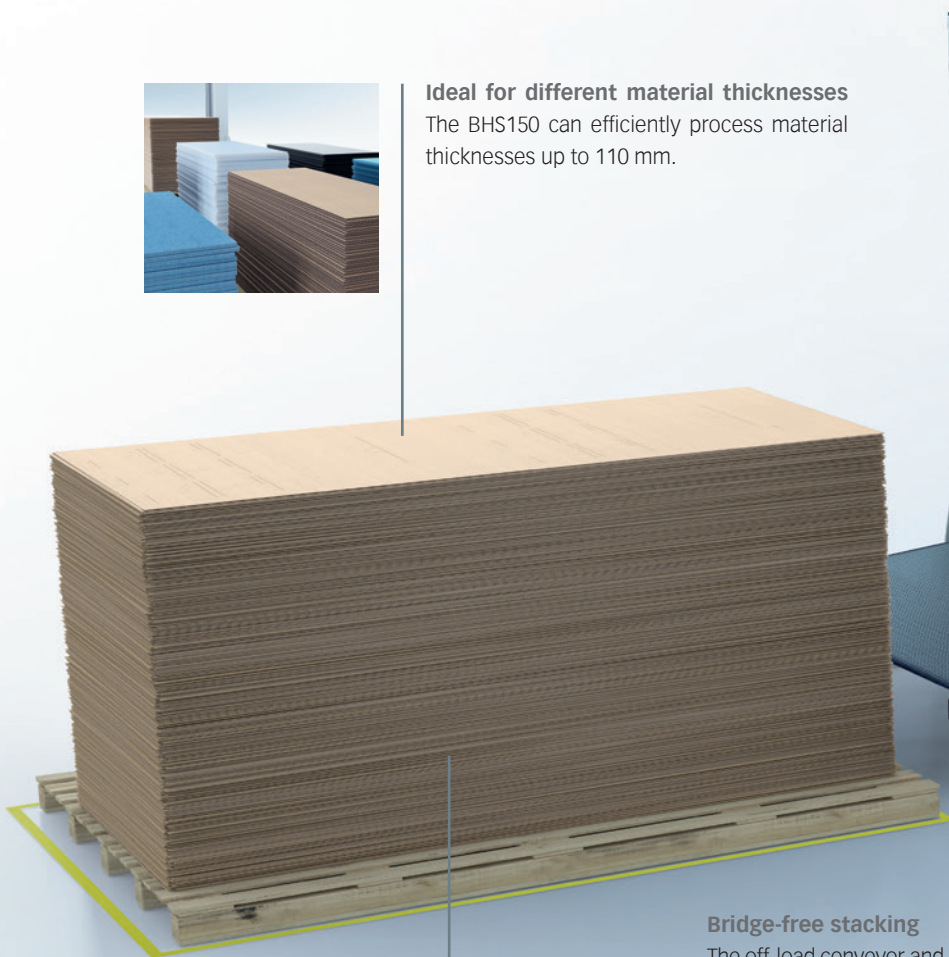

Bridge-free stacking
The off-load conveyor and stacking system deposits cut boards in a perfect stack on the pallet. Depending on the job, this stacking process eliminates the need for bridges to hold cut pieces in place. This facilitates separating cut parts from scrap, saving both time and money.

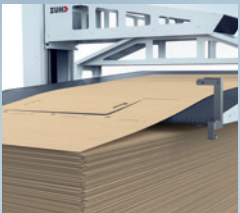

Efficient stacking with the BHS150
The stack height of 1.5m allows much longer uninterrupted operating time: long runs are finished efficiently and economically while finished stacks can be removed without interrupting the production process.



Economical even for smaller formats
The load unit can feed multiple sheets at once to make full use of the cutting area. This ensures maximum throughput even with smaller-format media.



Automatic job retrieval
During loading, the system automatically scans printed QR codes and retrieves corresponding file information. This enables reliably identifying different jobs within a stack for fully automated, non-stop processing.



Modular solutions
Cutting, creasing, perforating – Zünd's modular concept allows users to freely select processing methods. Up to three different methods can be used for any given job. No need to interrupt production for tool changes!

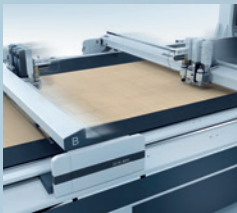
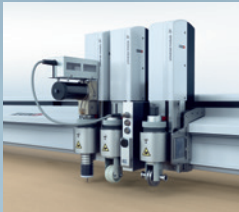

Top speed for maximum productivity
The BHS150 is designed for operation with the Zünd G3 and D3 cutter series. D3 dual-beam technology provides a significant increase in performance and thus offers maximum productivity.

Technical data

05/2019

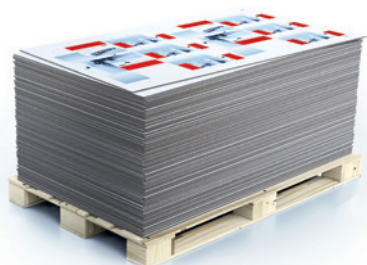

| Loading | | Board Handling System – BHS150 | | |
|----------------------|--------------------------------------|--------------------------------|------------------------------|------------------------------|
| max. board size | 1800 × 3200 mm (L line) | 2270 × 3200 mm (XL line) | 2740 × 3200 mm (2XL line) | 3210 × 3200 mm (3XL line) |
| max. board thickness | 110 mm (depending on beam height) | | | |
| max. board weight | 25 kg (per piece) | | | |
| max. stack height | 1500 mm (incl. pallet) | | | |

Zünd Systemtechnik AG
Industriestrasse 8
CH-9450 Altstätten
T +41 71 554 81 00
info@zund.com
www.zund.com